

J:\20150907\Dev\04\Sheets\development plan\10-Pedestrian Connectivity Planning, Last Saved By: sahara, 12/30/2015 9:41 AM Last Printed By: O'hara, Shaun, 12/30/2015 9:42 AM (No Xrefs)

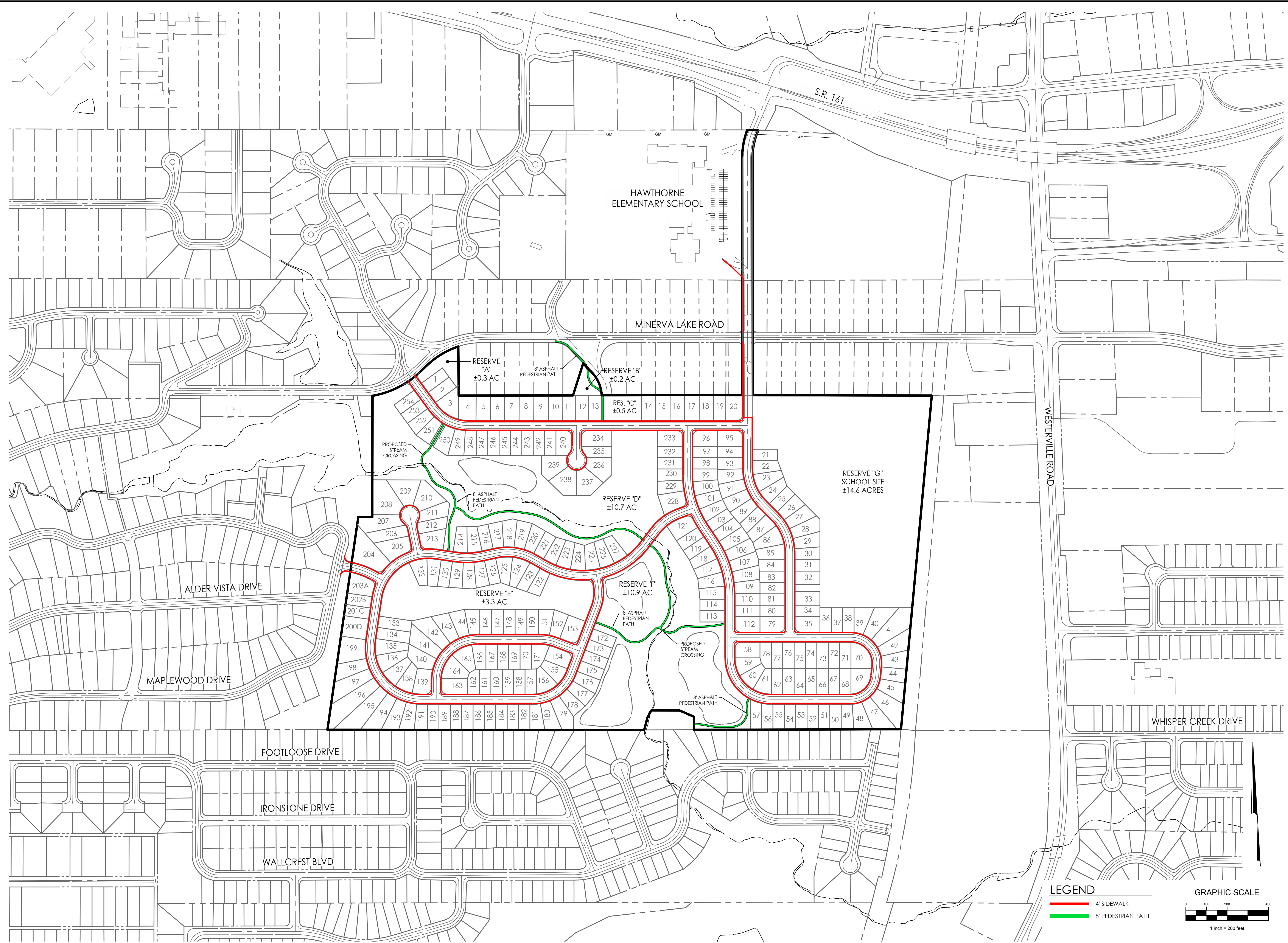

LEGEND

— 4' SIDEWALK
— 8' PEDESTRIAN PATH



MARK	DATE	DESCRIPTION	REVISIONS
123016		REVISED PER STAFF COMMENTS	
123015		REVISED PER STAFF COMMENTS	



MINERVA PARK, FRANKLIN COUNTY, OHIO
 PRELIMINARY PLAN / FINAL DEVELOPMENT PLAN
 FOR
MINERVA PARK
 PEDESTRIAN CONNECTIVITY PLAN



DATE
September 11, 2015

SCALE
1" = 200'

JOB NO.
20150907

SHEET
10/15